



Chapter 1 Embroidery Operation

Set Frame Origin: the frame origin need be set only once under any of the following circumstances: ① Starting using a new machine; ② Replacing the main board; ③ Updating data program;



A. Input Designs To Machine Memory

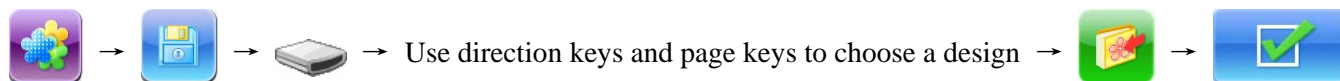

B. Choose A Design From Machine Memory

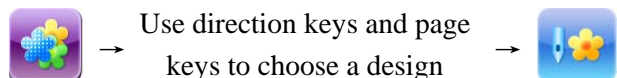

C. Set Design Parameters



D. Set Color Changing Sequence



E. Frame Select and Position

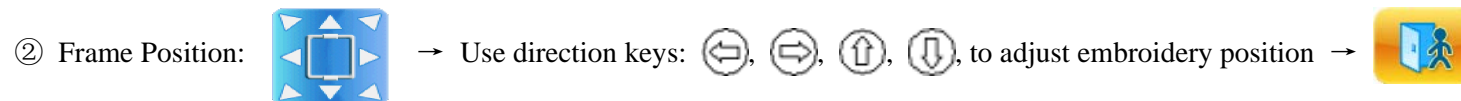

F. Embroidery Confirmation

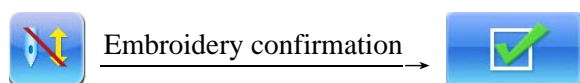

G. Start Embroidery

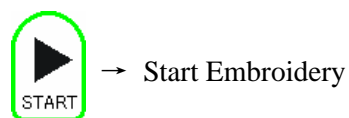

H. Embroidery Preparation

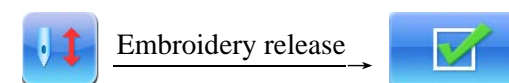

Releasing the embroidery, if user wants to start a new design. start the operation from step B “Choose a Design” again.



Chapter 2 Manual Operation

A. Manual Trimming



B. Manual Color-Changing



→ 【Select Needle Number】

C. Turn The Main Shaft To 100°



D. Return To Start Point

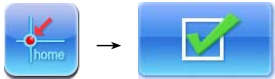

E. Return To Stop Point

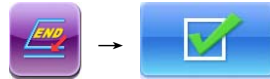

F. Tracing Design

Machine On
Needle # 1



→ Border / Outline Check



G. Positioning Idling



Normal Embroidery



High-speed Idling



Low-speed Idling

